

PRENSAFLUIDOS



GESTIÓN INTEGRAL DE EQUIPAMIENTOS INDUSTRIALES
INTEGRAL MANAGEMENT FOR INDUSTRIAL EQUIPMENTS



**ADVANCED FLUID
MANAGEMENT SOLUTIONS**



Quality
comes to
the surface



**ADVANCED FLUID
MANAGEMENT SOLUTIONS**



DESIGN IS AN

Art





founded in 1975



*the human side
of Quality*





from 180 to 220 kg drums



Strength points

The pneumatic piston pump hoists make the drum's exchange **simple** and **fast** thanks to the hoisting system with one or two columns activated pneumatically. Additionally, models equipped with the follower plate **will enable you to pump grease** even beyond the NLGI 3 grade, **highly viscous fluids** and even with high temperatures.

- **Facilitates the drum's exchange**

The new base allows the accommodation of a pallet, making the drum's substitution and its proper positioning easier.

- **Unparalleled efficiency**

The pneumatic control of the minimum and maximum drum's level allows the simplifying of work operations.

- **Adaptable with all types of pumps**

All RAASM pumps are usable thanks to the brackets and adaptors available on the catalog.

- **Work in safety**

The pressure control group allows the keeping of the pump pressure output under control.

- **Avoids air pockets in the drum**

Thanks to the visible bleeder, all internal air pockets are eliminated from the drum, leaving the work environment clean.

- **For extremely thick fluids**

Ideal for pumping fluids with high viscosity and grease even beyond the NLGI 3 grade (working temperature to be checked).



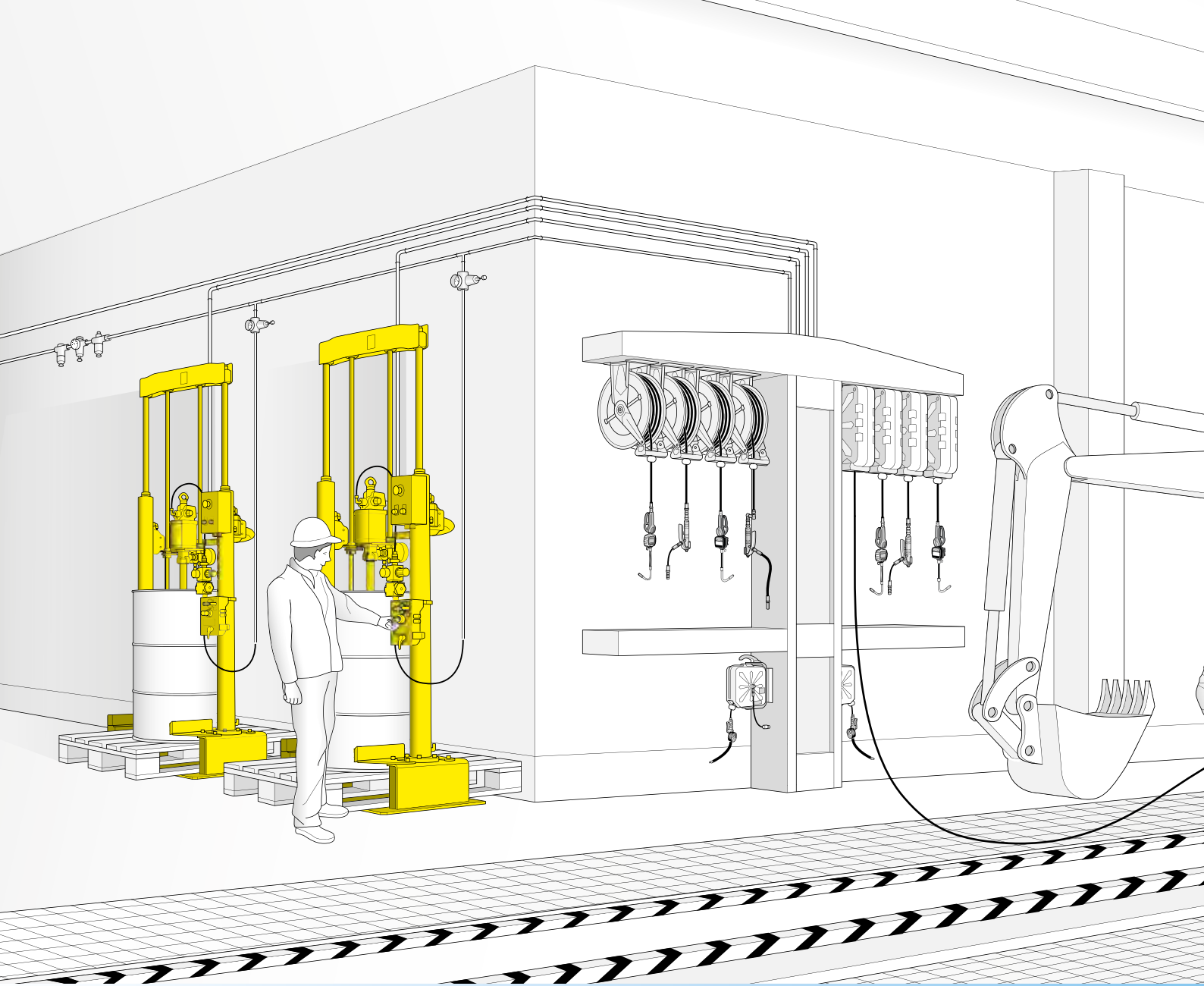

Mining

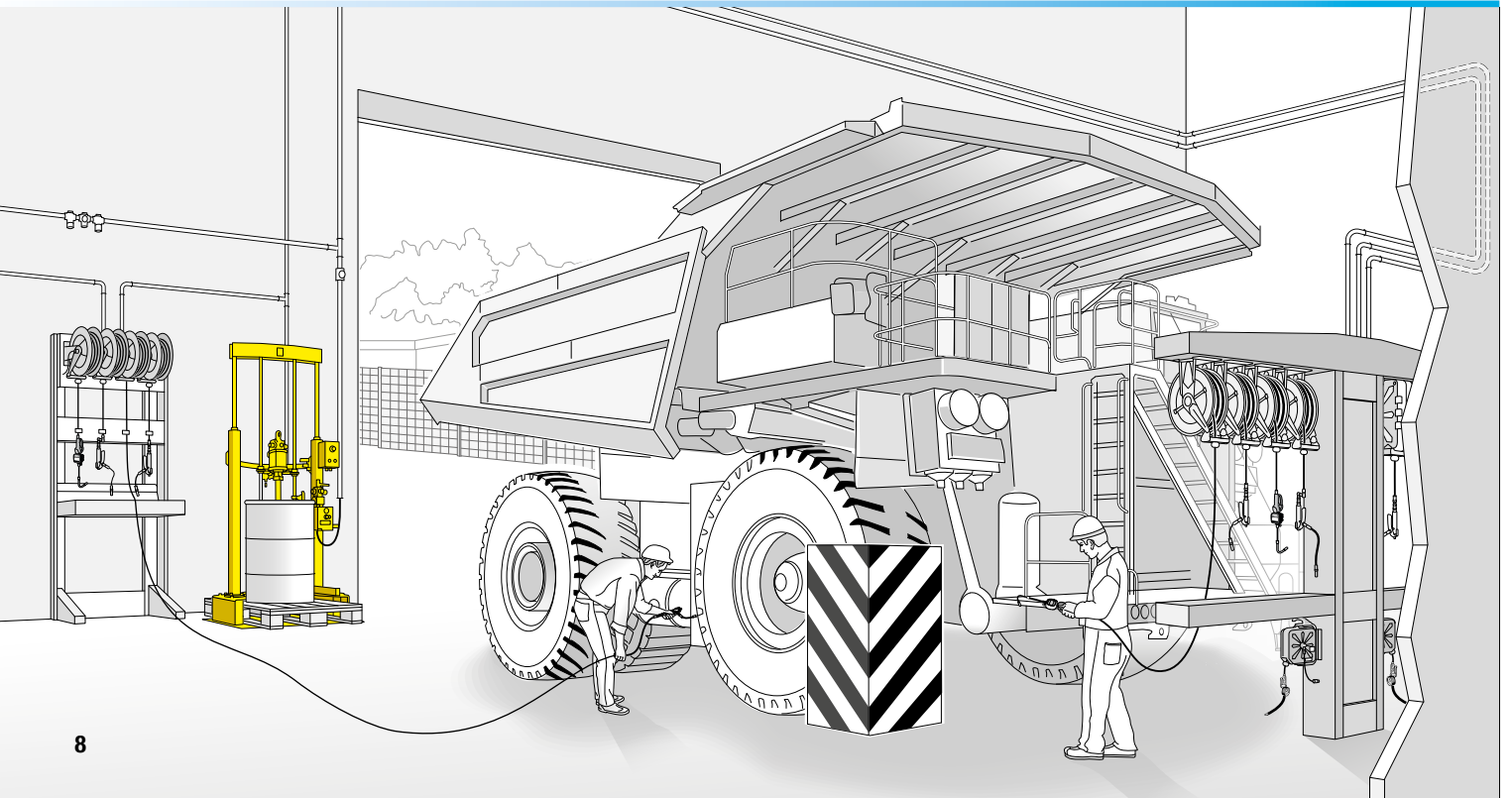



**ADVANCED FLUID
MANAGEMENT SOLUTIONS**

APPLICATION FIELDS

The hoists for pneumatic piston pumps, operating with follower plate, can compress **grease** even beyond the NLGI 3 grade, **very viscous fluids** and even with high temperatures.

These articles may be used in any industrial contest, requiring the substantial, fast and safe pumping of:

- greases
- oils
- industrial fluids
- paints
- inks
- silicones and glues
- resins
- ... and many others

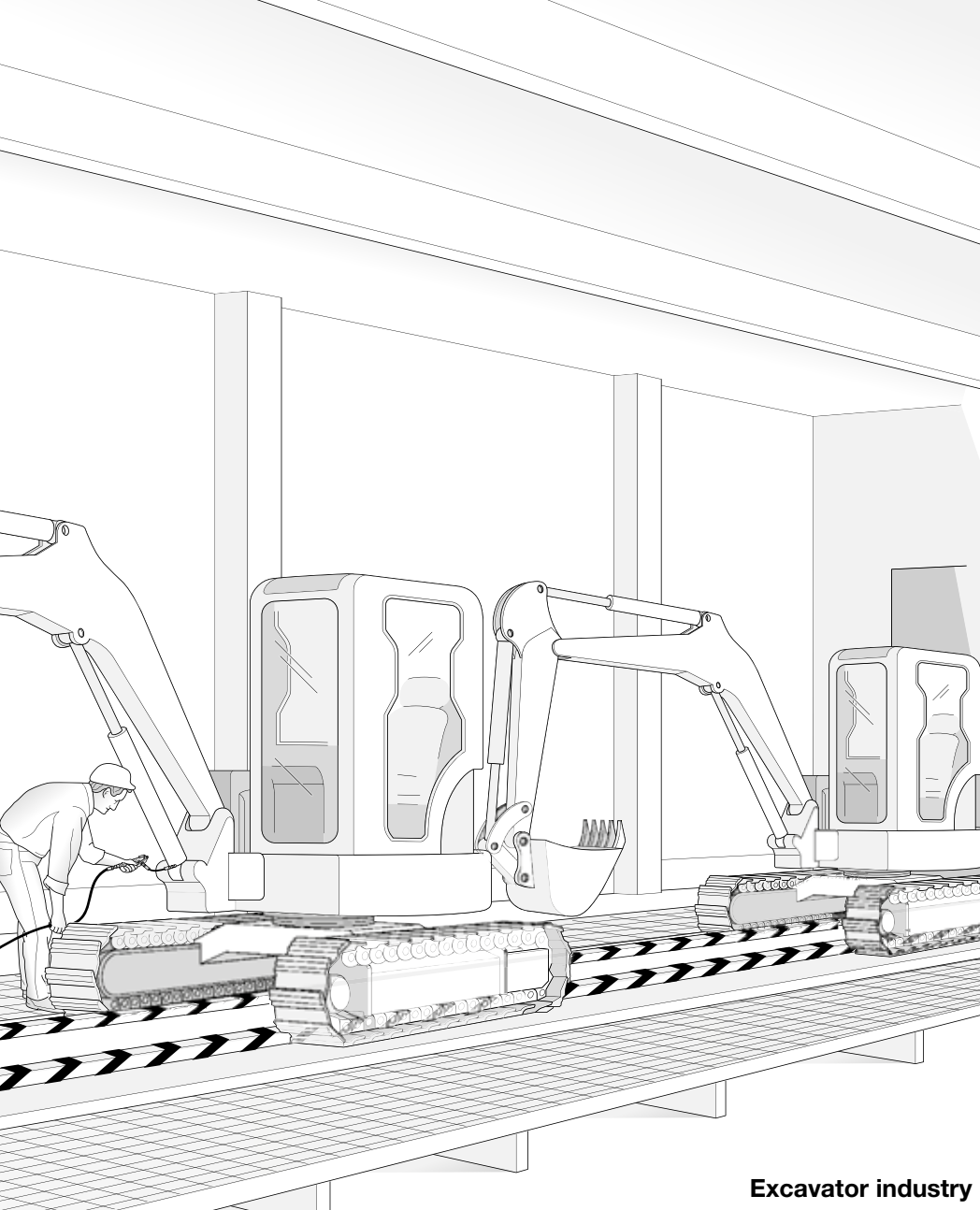

Excavator industry

Glues and paints industry

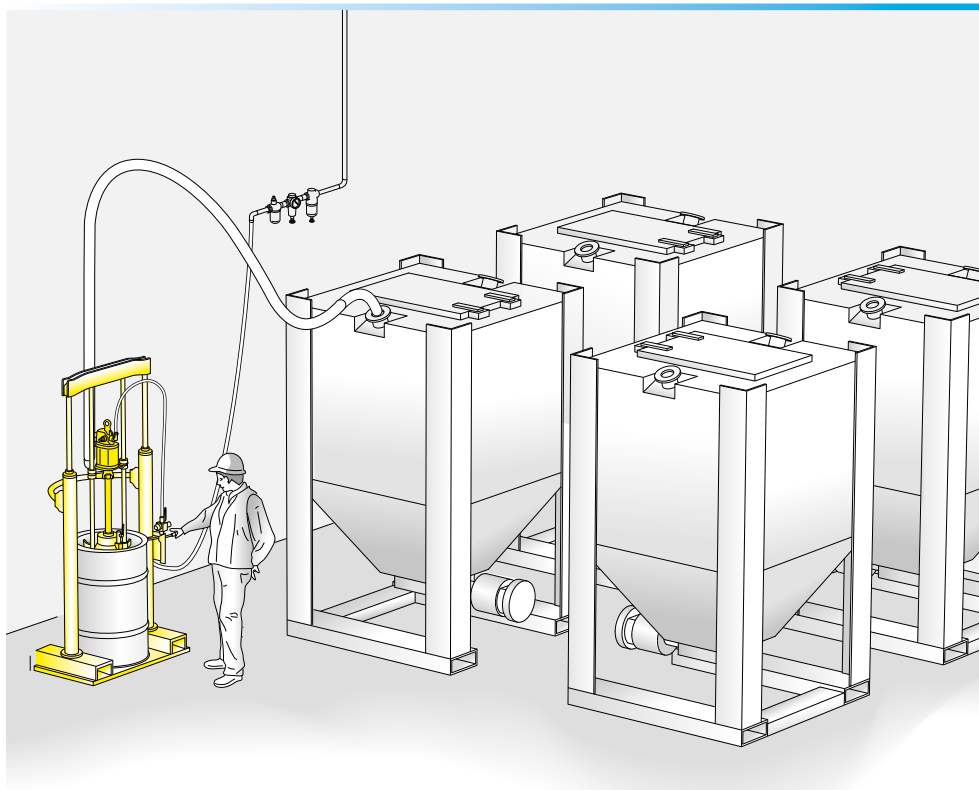

Ram hoists

TECHNICAL CHARACTERISTICS

FULL OPTIONAL

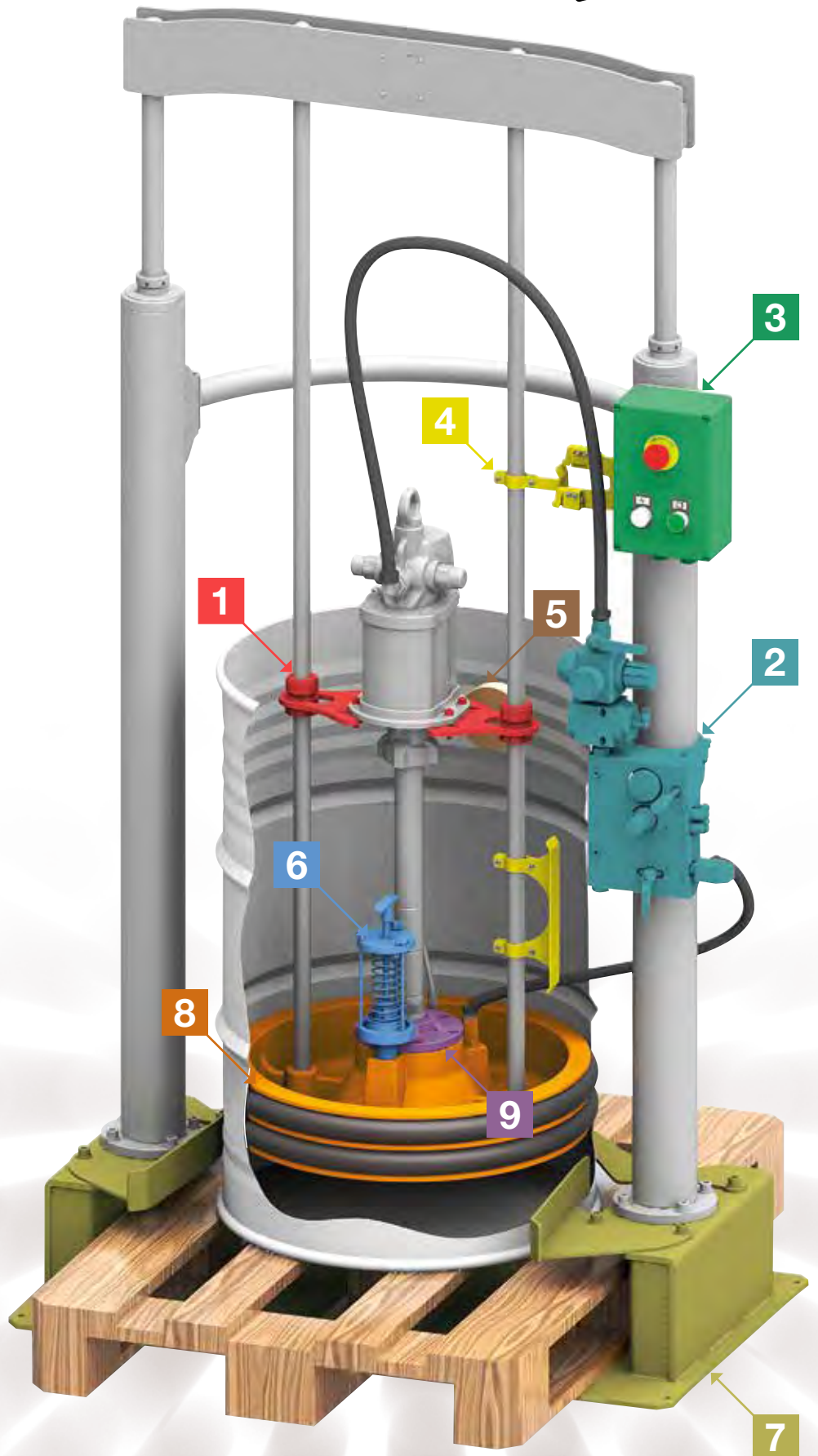

1 Support with pump positioning clamps

STANDARD BRACKETS

All the ram hoists are equipped with 2 standard brackets (**A - B**) suitable for mounting all our industrial pumps.

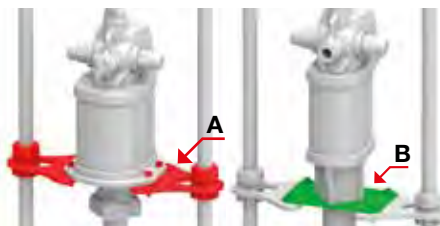

BRACKETS ON REQUEST

P/N 0713:

Support bracket suitable to mount pump with \varnothing 30 mm suction tube.

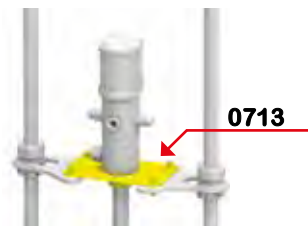

2 Pneumatic control panel

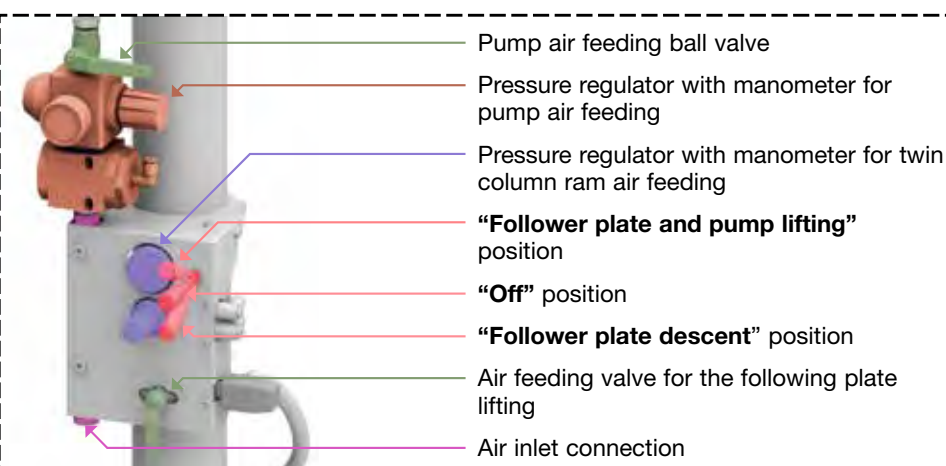

3 Electric-pneumatic hybrid control

4 Minimum and maximum drum level pneumatic control

5 Output pressure group control

6 Visible air bleeder

7 Base suitable for the accommodation of pallets with brackets to center the drum

8 P/N 6049
Follower plate \varnothing 585 mm with double sealing **NBR** ring, to be used with air operated twin column ram for drums from 180 to 220 kg. It can be used also with different kind of pumps thanks to special adaptors shown in the below list and available on request, see point 9.

Compatible fluids:
grease and lubricants also with high viscosity, industrial fluids, paints.

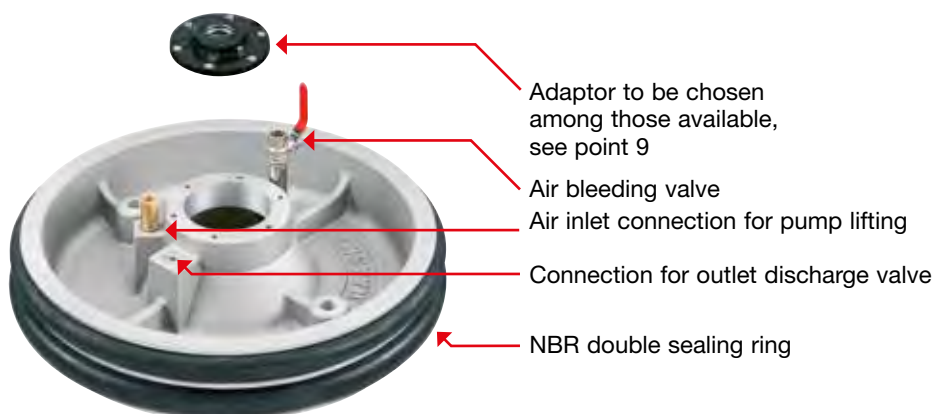

9



P/N 6067
Adaptor suitable for pumps with G 1" (f) suction tube



P/N 6068
Adaptor suitable for pumps with G 2" (f) suction tube

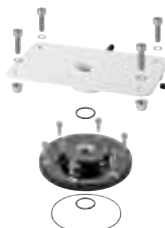

P/N 6069
Adaptor + Support (KR1102) suitable for pumps with \varnothing 30 mm suction tube



P/N 6070
Adaptor suitable for pumps with \varnothing 45 mm suction tube



P/N 6071
Adaptor suitable for pumps with \varnothing 50,8 mm suction tube



Air-operated pump elevator

The pump elevators are available in **single column (with or without basement)** or **twin column version**. It is raised by compressed air, via the side mounted 3-way valve that allows to change the drum easily and quickly.



**Comfortable drum change,
pump always mounted**



P/N	0712	0711	6034
Column	1 with basement	1 without basement	2 with basement
Suitable for drums	180 ÷ 220 kg	180 ÷ 220 kg	180 ÷ 220 kg
Working temperature	+2 ÷ +40 °C	+2 ÷ +40 °C	+2 ÷ +40 °C
Max pressure	8 bar	8 bar	8 bar
Usable pumps	s. 600 - 700 - 900 - 1200 - 1500 - 1800	s. 600 - 700 - 900 - 1200 - 1500 - 1800	s. 600 - 700 - 900 - 1200 - 1500 - 1800
Noise level	negligible (< 70 db)	negligible (< 70 db)	negligible (< 70 db)
Packing - Gross weight	N° 1 packing 1,16 m³ 97 kg	N° 1 packing 0,68 m³ 75 kg	N° 1 packing 1,41 m³ 128 kg
Height max/min (A - B)	2750 - 1750 mm	2715 - 1715 mm	2750 - 1750 mm
Dimensions (C - D)	866 - 630 mm	140 - 255 mm	1086 - 630 mm

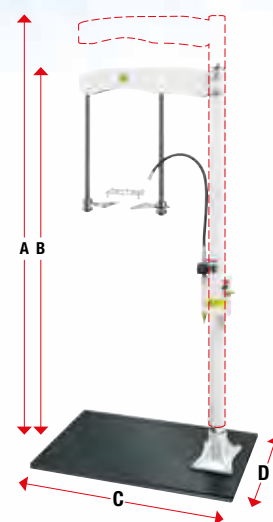

PERSONALIZED KIT

In order to satisfy any particular need it is possible to create a **"Personalized kit"**. According to the kind of fluids, please follow the specific column and choose the right part number in each one of the 3 steps:

GREASE AND VISCOUS FLUIDS PROCEDURE

Choose the ram hoist (see page on the left), and then complete your kit with **Pump**, **Follower plate** and **Drum cover**.

1

Grease and viscous fluids pumps



P/N	0049	0052	0053	6005	0941	5967	5982
Series	600	700	900	900	1200	1200	1500
Ratio	50:1	65:1	45:1	70:1	75:1	40:1	70:1
Flow rate	1500 g/min	1900 g/min	4400 g/min	3000 g/min	4400 g/min	10000 g/min	7000 g/min
Seals	polyurethane	polyurethane	polyurethane	polyurethane	polyurethane	polyurethane	polyurethane
Suct. tube	940-ø 30 mm	940-ø 30 mm	940-ø 45 mm	940-ø 45 mm	940-ø 45 mm	940-ø 50,8 mm	940-ø 50,8 mm

2

Grease and viscous fluids follower plate



P/N **0062**
Follower plate ø 585 mm for pumps with suction tube ø 30 mm

P/N **0063**
Follower plate ø 585 mm for pumps with suction tube ø 45 mm

P/N **6111**
Follower plate ø 585 mm for pumps with suction tube ø 50,8 mm

3

Grease and viscous fluids drum cover



P/N **0057**
Drum cover ø 600 mm for pumps with suction tube ø 30 mm

P/N **0058**
Drum cover ø 600 mm for pumps with suction tube ø 45 mm

P/N **6104**
Drum cover ø 600 mm for pumps with suction tube ø 50,8 mm

Example

The kit is ready to use.



OIL AND INDUSTRIAL FLUIDS PROCEDURE

Choose the ram hoist (see page on the left), and then complete your kit with **Pump**, **Follower plate** and **Bung adaptor**.

Oil and viscous fluids pumps



P/N	6006	6009	6004	6007	5965	5966
Series	900	900	900	900	1200	1200
Ratio	7:1	7:1	11:1	11:1	12:1	18:1
Flow rate	30 l/min	30 l/min	30 l/min	30 l/min	30 l/min	23 l/min
Seals	polyurethane	polyurethane	polyurethane	polyurethane	polyurethane	polyurethane
Suct. tube	940 - ø 53 mm	940 - ø 53 mm	940 - ø 45 mm	940 - ø 45 mm	940 - ø 53 mm	940 - ø 45 mm

Oil and viscous fluids drum cover



P/N **0058**
Drum cover ø 600 mm for pumps with suction tube ø 45 mm

P/N **4635**
Drum cover ø 600 mm with thread union G 2" (f)

Oil and viscous fluids bung adaptor



P/N **6089**
Bung adaptor for pumps with suction tube ø 45 mm

P/N **0007**
Bung adaptor for pumps with suction tube ø 50 mm

P/N **1078**
Bung adaptor for pumps with suction tube ø 50,8 mm

Example

The kit is ready to use.





Ram hoists

The two versions P/N **6035** and P/N **6055** include the use of a **follower plate with double seal** to facilitate the pumping of grease with high viscosity. They differ according to the type of accommodation base for pallet.

- ✓ Simple positioning drum, efficient with viscous grease



P/N	6035	6055
Column	2	2
Suitable for drums	180 ÷ 220 kg	180 ÷ 220 kg
Working temperature	+2 ÷ +40 °C	+2 ÷ +40 °C
Max pressure	8 bar	8 bar
Usable pumps	s. 600 - 700 - 900 - 1200 - 1500 - 1800	s. 600 - 700 - 900 - 1200 - 1500 - 1800
Noise level	negligible (< 70 db)	negligible (< 70 db)
Pushing force downwards at:	4 bar 432 kg - 6 bar 648 kg - 8 bar 864 kg	4 bar 432 kg - 6 bar 648 kg - 8 bar 864 kg
Basement accommodation pallet	-	11/101
Packing - Gross weight	☐ N° 1 packing 1,84 m³ ☐ 187 kg	☐ N° 1 packing 1,84 m³ ☐ 190 kg
Height max/min (A - B)	2800 - 1800 mm	2800 - 1800 mm
Dimensions (C - D)	1086 - 630 mm	1086 - 630 mm

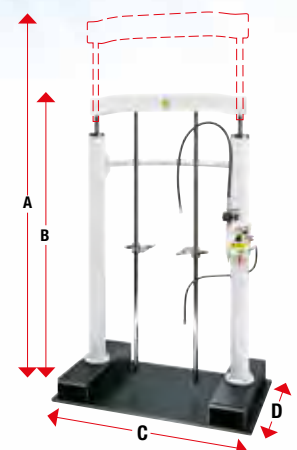

* theoretical valves, friction coefficient has not been considered. Furthermore depression's force created by the pump during suction (+2100 kg) must be added to the listed figures.

PERSONALIZED KIT

In order to satisfy any particular need it is possible to create a “**Personalized kit**”. According to the kind of fluids choose the right part number in each one of the **4 steps**:

1

Grease, viscous fluids, oil and industrial fluids pumps

Choose the ram hoist (see page on the left), and then complete your kit according with your needs with one of the industrial pump below. We introduce the main versions but all the RAASM industrial pumps are suitable.



P/N	5979	5987	5997	5958	6003	5964	5973	5985
Series	1500	1800	900	1200	900	1200	1200	1500
Ratio	6:1	8:1	11:1	18:1	45:1	75:1	40:1	70:1
Flow rate	80 l/min	65 l/min	30 l/min	23 l/min	4400 g/min	4400 g/min	10000 g/min	7000 g/min
Seals	polyurethane	polyurethane	polyurethane	polyurethane	polyurethane	polyurethane	polyurethane	polyurethane
Suct. tube	G 2" (f)	G 2" (f)	480 - ø 45 mm	480 - ø 45 mm	500 - ø 45 mm	500 - ø 45 mm	600 - ø 50,8 mm	600 - ø 50,8 mm

2

Follower plate

Add to the kit the follower plate with double seal P/N 6049.



P/N 6049
Follower plate ø 585 mm
with NBR double seal ring.

3

Adaptor

Choose the adaptor to mount on the follower plate P/N 11/60 according with the pump suction tube diameter.



P/N 6067
Adaptor suitable for pumps with G 1" (f) suction tube.

P/N 6068
Adaptor suitable for pumps with G 2" (f) suction tube.

P/N 6069
Adaptor suitable for pumps with ø 45 mm suction tube.

P/N 6070
Adaptor + Support (KR1102) suitable for pumps with ø 30 mm suction tube.

P/N 6071
Adaptor suitable for pumps with ø 50,8 mm suction tube.

4

Optional

If you need or if you want something more add one of the available optional introduced on page 19.



Example

The kit is ready to use.





Ram hoist kits

Air-operated twin column ram hoist with industrial pump.

It is raised and lowered by compressed air, via the side mounted 3-way valve. Essential when pumping high viscosity and heavy fluids since ram pushes down the follower plate helping pump working. It is suitable for 180 ÷ 220 kg drums.



useful with higher
viscosity grease
and higher distances



P/N	6029	6031	6024	6026	
Twin column ram	6035	6035	6035	6035	
Follower plate in NBR	6049	6049	6049	6049	
Adaptor	6068	6068	6070	6070	
Pump with seals in PU	5979	5987	5997	5958	
Ratio	6:1	8:1	11:1	18:1	
Flow rate	80 l/min	65 l/min	30 l/min	23 l/min	
Suction tube	G 2" (f)	G 2" (f)	ø 45 mm	ø 45 mm	
Pump connection hose	150 bar	150 bar	150 bar	150 bar	
Follower plate connection hose	150 bar	150 bar	150 bar	150 bar	
Suitable for drums	180 ÷ 220 kg	180 ÷ 220 kg	180 ÷ 220 kg	180 ÷ 220 kg	
Packing - Gross weight	N° 1 packing 1,80 m³ 247 kg	N° 1 packing 1,80 m³ 250 kg	N° 1 packing 1,80 m³ 220 kg	N° 1 packing 1,80 m³ 224 kg	
Height max/min (A - B)	2800 - 1800 mm	2800 - 1800 mm	2800 - 1800 mm	2800 - 1800 mm	
Dimensions (C - D)	1086 - 630 mm	1086 - 630 mm	1086 - 630 mm	1086 - 630 mm	

The kits offered in these two pages differ in the industrial pneumatic pumps installed. Usable with drums from 180 ÷ to 220 kg, they are designed to pump also very viscous fluids and grease at various distances. According to the personal needs, choose the most suitable model and, eventually, personalize it with the accessories on page 19.



6027	6025	6028	6030
6035	6035	6035	6035
6049	6049	6049	6049
6071	6070	6070	6071
5793	6003	5964	5985
40:1	45:1	75:1	70:1
10 kg/min	4,4 kg/min	4,4 kg/min	7 kg/min
ø 50,8 mm	ø 45 mm	ø 45 mm	ø 50,8 mm
150 bar	150 bar	150 bar	150 bar
150 bar	150 bar	150 bar	150 bar
180 ÷ 220 kg	180 ÷ 220 kg	180 ÷ 220 kg	180 ÷ 220 kg
N° 1 packing 1,80 m³ 225 kg	N° 1 packing 1,80 m³ 223 kg	N° 1 packing 1,80 m³ 225 kg	N° 1 packing 1,80 m³ 231 kg
2800 - 1800 mm	2800 - 1800 mm	2800 - 1800 mm	2800 - 1800 mm
1086 - 630 mm	1086 - 630 mm	1086 - 630 mm	1086 - 630 mm

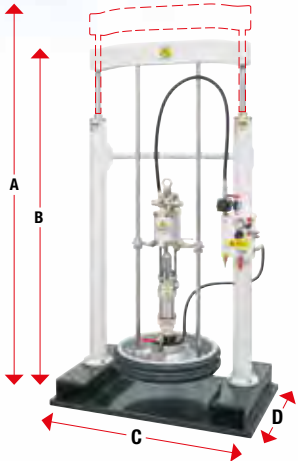



Ram hoist kits

Air operated twin column ram hoist with industrial pump. The underlying models include as a standard accessory the accommodation base pallet, essential for positioning easily and correctly the pallet where the drum rests. Additionally, various accessories are available, which increase the safety and functionality of the article, assembled singularly or simultaneously according to the code. Only the model "Full Optional" P/N **6045** presents all the equipment listed on pages 10 and 11. Kits are suitable for drums from 180 ÷ to 220 kg.



**Customizable for
higher safety
and functionality**

FULLOPTIONAL
see page 10-11



P/N	6041	6044	6042	6045
Twin column ram	6055	6055	6055	6055
Follower plate in NBR	6049	6049	6049	6049
Adaptor	6071	6070	6071	6070
Pump with seals in PU	5973	5964	5973	5964
Ratio	40:1	75:1	40:1	75:1
Flow rate	10 kg/min	4,4 kg/min	10 kg/min	4,4 kg/min
Suction tube	ø 50,8 mm	ø 45 mm	ø 50,8 mm	ø 45 mm
Pump connection hose	150 bar	150 bar	150 bar	150 bar
Follower plate connection hose	150 bar	150 bar	150 bar	150 bar
Suitable for drums	180 ÷ 220 kg	180 ÷ 220 kg	180 ÷ 220 kg	180 ÷ 220 kg
Pneumatic limit switch	-	-	6046	6046
Visible drain valve	-	-	6038	6038
Electric pneumatic hybrid control	-	-	-	6047
Outlet pressure relief valve	-	-	-	6039
Packing - Gross weight	<div> <div>N° 1 packing 1,80 m³</div> <div>275 kg</div> </div>	<div> <div>N° 1 packing 1,80 m³</div> <div>215 kg</div> </div>	<div> <div>N° 1 packing 1,80 m³</div> <div>282 kg</div> </div>	<div> <div>N° 1 packing 1,80 m³</div> <div>234 kg</div> </div>
Height max/min (A - B)	2950 - 1950 mm	2950 - 1950 mm	2950 - 1950 mm	2950 - 1950 mm
Dimensions (C - D)	1086 - 630 mm	1086 - 630 mm	1086 - 630 mm	1086 - 630 mm

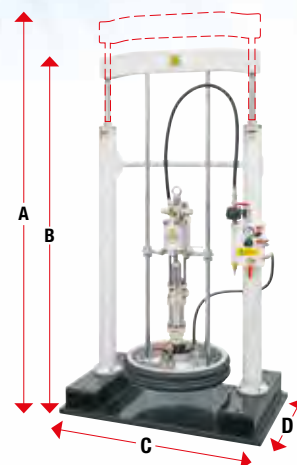



Ram hoist accessories from 180 to 220 kg



P/N 6040
System maximum pressure relief valve (pump output), which can be manually set



P/N 6039
(to integrate with P/N 6047) **Outlet pneumatic system pressure relief valve**



P/N 6047
(to integrate with P/N 6039)
Hybrid electric-pneumatic control: features a system discharge timer manually settable, which activates valve P/N 6039

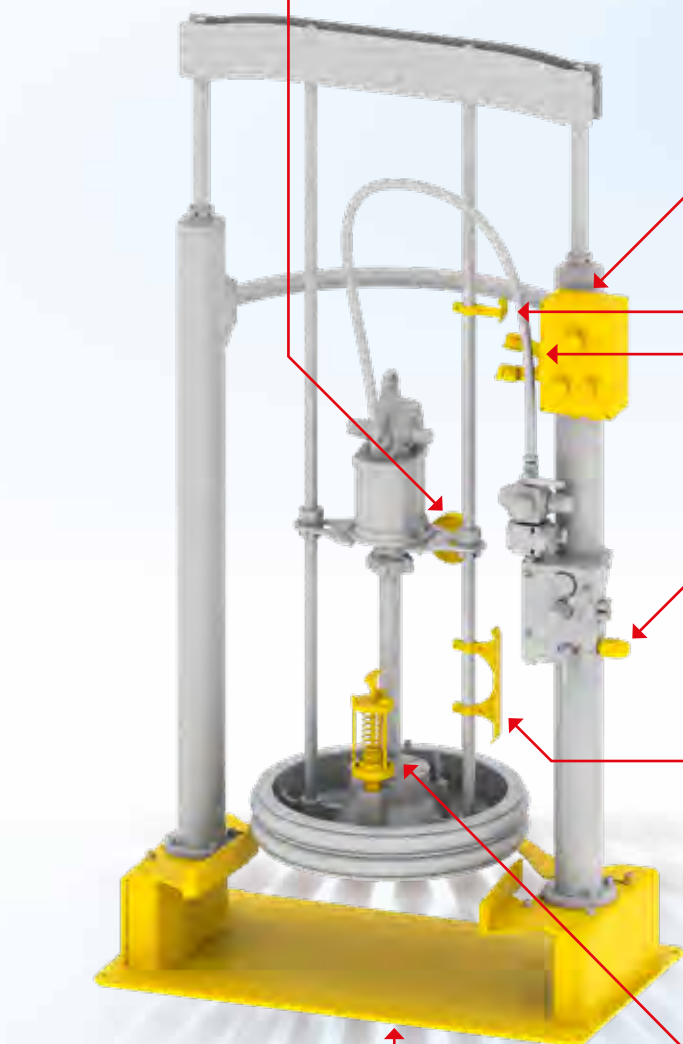

P/N 6046
Pneumatic controls of the maximum and minimum drum's levels



P/N 6037
Hoist base for pallet accommodation to facilitate drum's substitution



P/N 6038
Visible air bleeder for fluid press hoist: eliminates air pockets inside the drum, leaving a clean environment



from 18 to 30 kg drums





**ADVANCED FLUID
MANAGEMENT SOLUTIONS**

APPLICATION FIELDS

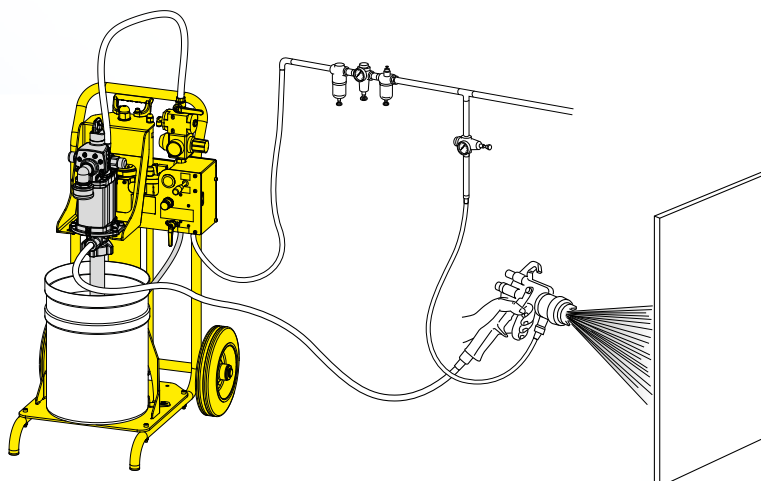

Fluid distribution system
(for paints, lubricants, protective liquids, etc.)
with spray gun.

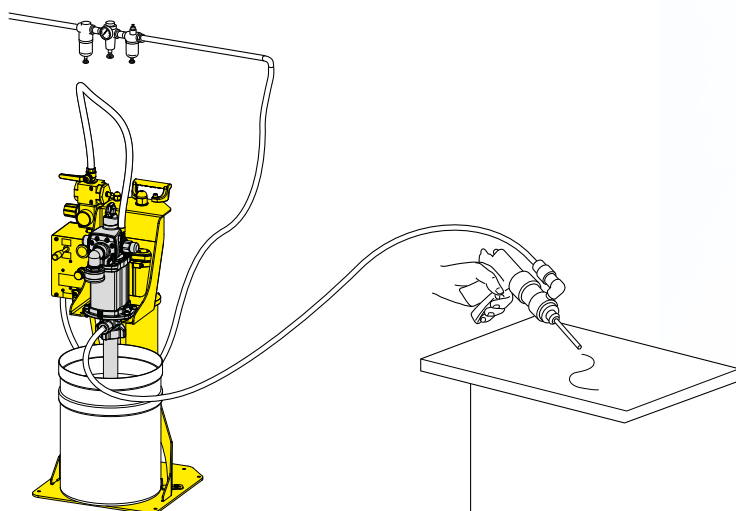

Automated system for the delivery of preselected quantities
of fluids (inks, paints, greases, etc.).

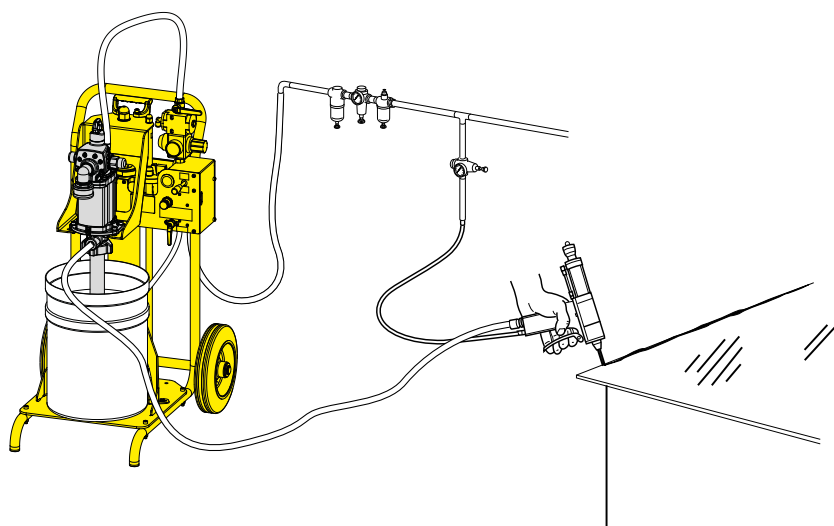

Application of sealants, adhesives, greases, etc.,
by means of special delivery gun.

The pneumatic piston pump hoists, operating with follower plate, can compress **grease** even beyond the NLGI 3 grade, **very viscous fluids** and even with particularly high temperatures.

These articles can be used in any industrial contest that might need the substantial, fast and safe pumping:

- greases
- oils
- industrial fluids
- paints
- inks
- silicones and glues
- resins
- ... and many others

Ram hoists

TECHNICAL CHARACTERISTICS

FULL OPTIONAL

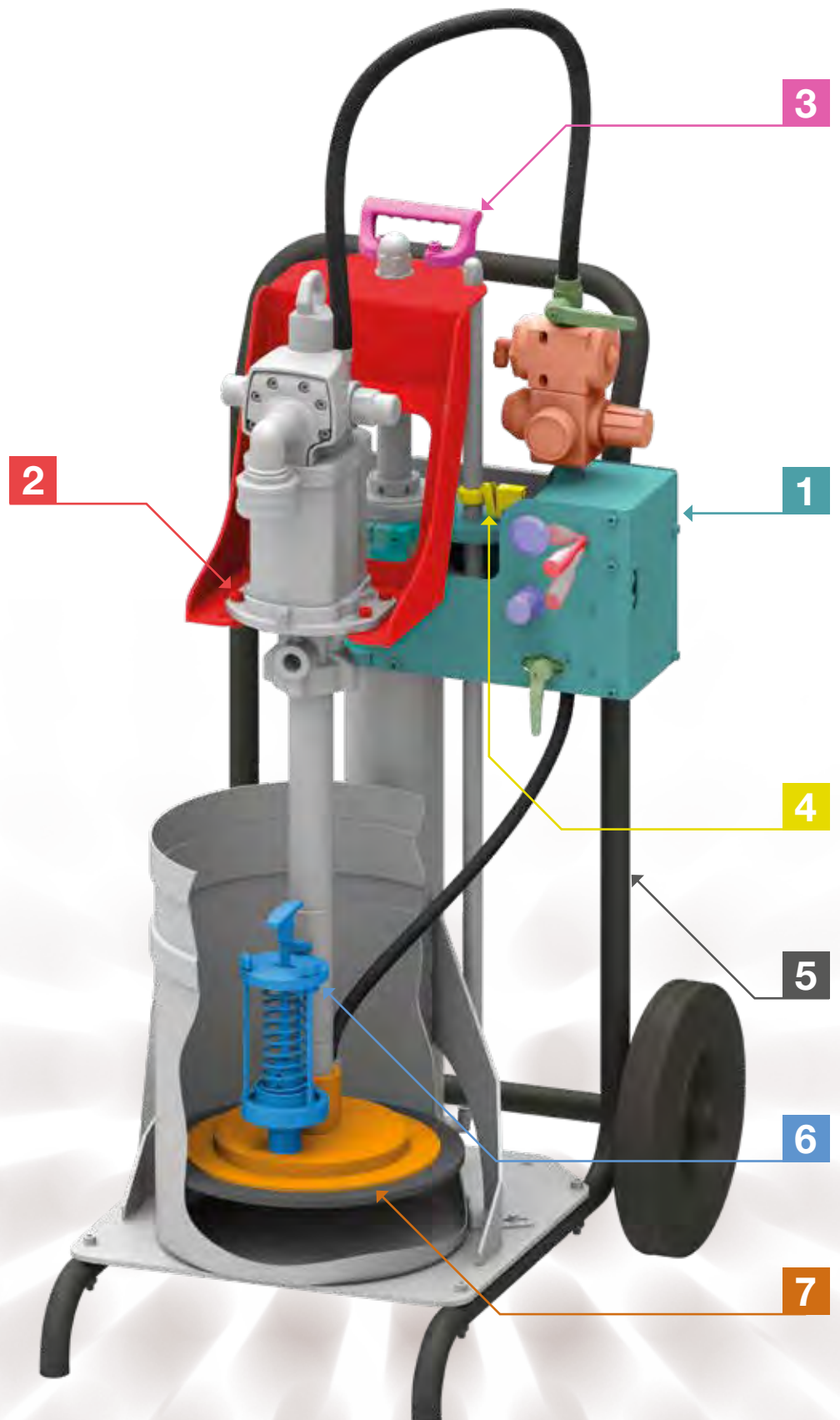

1 Pneumatic control panel

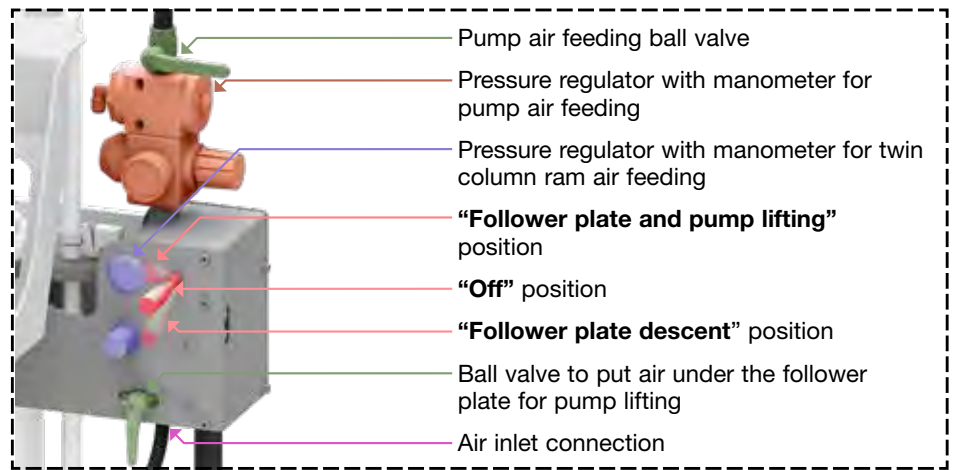

2 Support with pump positioning clamps

5 Trolley for the kit

3 Handle to facilitate the moving of the cart

6 Visible air bleeder

4 Minimum drum level pneumatic control

7 Follower plate

Strength points

- **Facilitates the exchange of the drum:** the base allows both the drum's exchange and its correct positioning.
- **Unparalleled efficiency:** the pneumatic control of the drum's minimum level simplifies the work operations.
- **Convenience in any situation:** the drum's movable cart allows the easy moving of the pump to get close to the distribution point.
- **For small size drums:** designed to accommodate the needs of those who work with drums from 18 to 30 kg.
- **Avoids air pockets in the drum:** thanks to the visible air bleeder, all air pockets are eliminated from inside the drum, leaving a clean work environment.
- **For extremely dense fluids:** ideal for pumping fluids with high viscosity and grease beyond even the NLGI 3 grade (work temperature to be checked).



Ram hoists from 18 to 30 kg

Air-operated single column ram hoist with industrial pump. It is raised and lowered by compressed air, via the side mounted 3-way valve. Essential when pumping high viscosity and heavy fluids since ram pushes down the follower plate helping pump working. It is suitable for 18 - 30 kg drums. **The follower plate available on request, is suitable for drums with max diameter 310 mm and max height 490 mm.**



Comfortable and safety



P/N	6065	6066
Suitable for drums	18 ÷ 30 kg	18 ÷ 30 kg
Minimum level pneumatic control	-	12/130
Working temperature	+2 ÷ +40 °C	
Max pressure	3 bar	
Usable pumps	s. 900 - 1200	
Noise level	negligible (< 70 db)	
Pushing force downwards at:	1 bar 55 kg - 1,5 bar 81 kg	
Packing - Gross weight	N° 1 packing 0,30 m³ 61,1 kg	N° 1 packing 0,30 m³ 61,6 kg
Height max/min (A - B)	1460 - 970 mm	1460 - 970 mm
Dimensions (C - D)	500 - 480 mm	500 - 480 mm

* theoretical valves, friction coefficient has not been considered. Furthermore depression's force created by the pump during suction (+2100 kg) must be added to the listed figures.

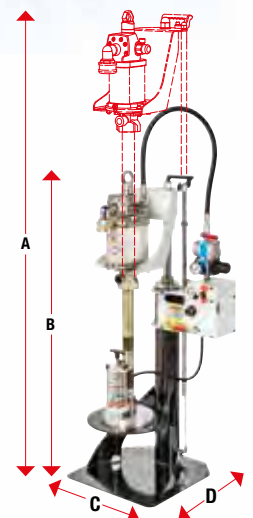



PERSONALIZED KIT

In order to satisfy any particular need it is possible to create a “**Personalized kit**”. According to the kind of fluids, choose the right part number in each one of the **4 steps**:

1

Grease, viscous fluids, oil and industrial fluids pumps

Choose the ram hoist (see page on the left), and then complete your kit according with your needs with one of the industrial pump below.

		
P/N	6002	5963
Series	900	1200
Ratio	45:1	75:1
Flow rate	4400 g/min	4400 g/min
Seals	PU	PU
Suct. tube	500 - ø 45 mm	500 - ø 45 mm

2

Follower plate

Add to the kit the follower plate.



P/N 6048
Follower plate ø 310 mm
with NBR seal ring and
suction tube adaptor ø 45 mm
(for drum with internal ø
from 260 to 310 mm)

3

Trolley

Choose if you want a mobile unit.



P/N 4691
Trolley for ram hoist
from 18 to 30 kg

4

Optional

If you need something more add one of the available optional introduced on page 28.



Example

The kit
is ready
to use.





Ram hoist kits

Air operated single column ram hoist with industrial pump.

The following models, with or without trolley, provide some useful accessories to increase the safety and functionality of the article, assembled singularly or simultaneously, according to the code. Only the models "Full Optional"

P/N **6075** and P/N **6079** present all the equipment listed on pages 22 and 23. Kits are suitable for drums from 18 to 30 kg. **The available membrane is suitable for drums with a max ø of 310 mm and a max height of 490 mm.**



**Flexibility
and safety**



P/N without TROLLEY	6056	6060	6057	6061	
P/N with TROLLEY	6072	6076	6073	6077	
Twin column ram	6065	6065	6065	6065	
Follower plate in NBR	6048	6048	6048	6048	
Pump with seals in PU	6002	5963	6002	5963	
Ratio	45:1	75:1	45:1	75:1	
Flow rate	4400 g/min	4400 g/min	4400 g/min	4400 g/min	
Suction tube	500 mm	500 mm	500 mm	500 mm	
Visible air bleeder	-	-	6038	6038	
Minimum level pneumatic control	-	-	-	-	
Pump connection hose	150 bar	150 bar	150 bar	150 bar	
Follower plate connection hose	20 bar	20 bar	20 bar	20 bar	
Suitable for drums	18 ÷ 30 kg	18 ÷ 30 kg	18 ÷ 30 kg	18 ÷ 30 kg	
Packing - Gross weight (without trolley)	📦 N° 1 packing 0,58 m³ 79,4 kg	📦 N° 1 packing 0,58 m³ 80,6 kg	📦 N° 1 packing 0,58 m³ 80,0 kg	📦 N° 1 packing 0,58 m³ 81,6 kg	
Packing - Gross weight (with trolley)	📦 N° 1 packing 0,58 m³ 96,1 kg	📦 N° 1 packing 0,58 m³ 97,3 kg	📦 N° 1 packing 0,58 m³ 76,7 kg	📦 N° 1 packing 0,58 m³ 98,3 kg	
Height max/min (A - B)	1560 - 1070 mm	1560 - 1070 mm	1560 - 1070 mm	1560 - 1070 mm	
Dimensions (C - D)	610 - 725 mm	610 - 725 mm	610 - 725 mm	610 - 725 mm	

* dimensions without trolley see page 24

Kits P/N 6075 and P/N 6079 on this page feature all the available accessories to make the single column ram hoist the most performant possible. In particular, kits are on movable trolley to facilitate the moving of the pump and they offer the visible air bleeder and the pneumatic control of the minimum level of the drum.

FULLOPTIONAL
see page 22-23



	6058	6062	6059	6063
	6074	6078	6075	6079
	6066	6066	6066	6066
	6048	6048	6048	6048
	6002	5963	6002	5963
	45:1	75:1	45:1	75:1
	4400 g/min	4400 g/min	4400 g/min	4400 g/min
	500 mm	500 mm	500 mm	500 mm
	-	-	6038	6038
	6064	6064	6064	6064
	150 bar	150 bar	150 bar	150 bar
	20 bar	20 bar	20 bar	20 bar
	18 ÷ 30 kg	18 ÷ 30 kg	18 ÷ 30 kg	18 ÷ 30 kg
	N° 1 packing 0,58 m³ kg 80,0	N° 1 packing 0,58 m³ 81,5 kg	N° 1 packing 0,58 m³ 81,1 kg	N° 1 packing 0,58 m³ 82,1 kg
	N° 1 packing 0,58 m³ kg 96,6	N° 1 packing 0,58 m³ 98,2 kg	N° 1 packing 0,58 m³ 97,8 kg	N° 1 packing 0,58 m³ 98,8 kg
	1560 - 1070 mm	1560 - 1070 mm	1560 - 1070 mm	1560 - 1070 mm
	610 - 725 mm	610 - 725 mm	610 - 725 mm	610 - 725 mm

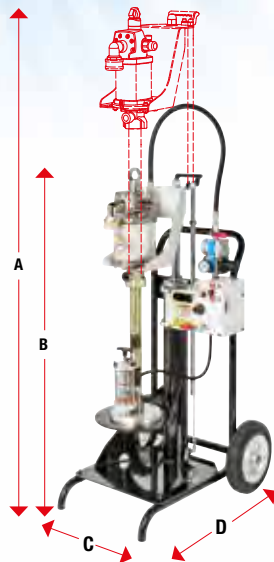



Ram hoist accessories 18 ÷ 30 kg



P/N 6040
System pressure
relief valve



P/N 6064
Pneumatic control
of the minimum
drum's level



P/N 6038
Visible air bleeder for fluid
press hoist, eliminates air
pockets inside the drum
leaving the environment
clean

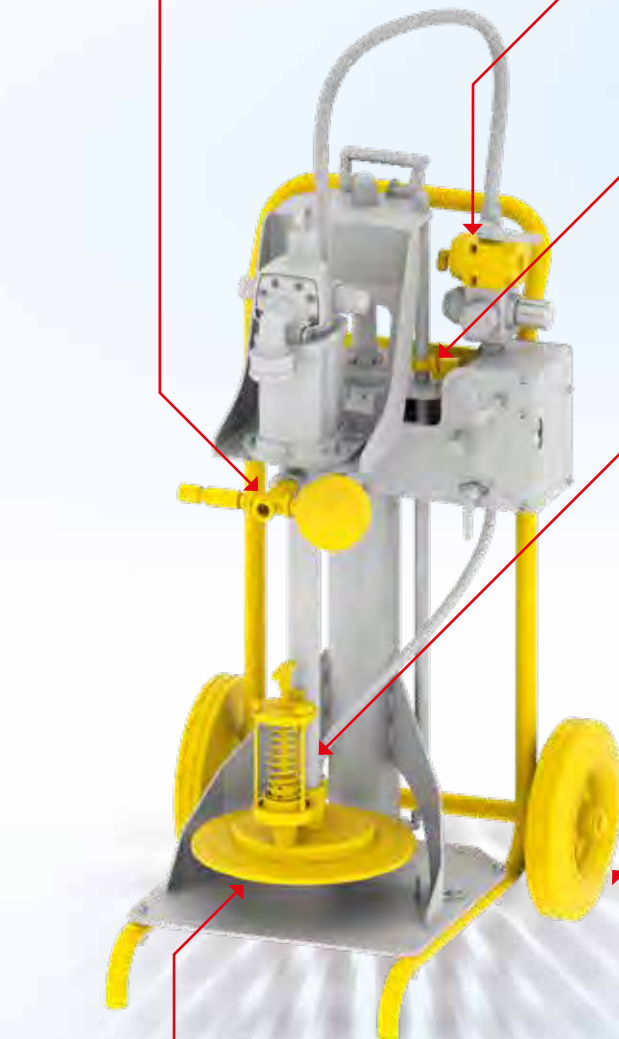

P/N 4691
Trolley for ram hoist
from 18 to 30 kg

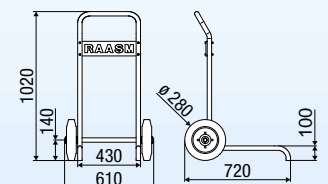

P/N 6048
Follower plate
ø 310 mm
with NBR seal ring
and suction tube
adaptor ø 45 mm
(for drum with internal
ø from 260 to 310 mm)



TECNOLOGÍA

La investigación y el desarrollo de nuevas soluciones que acabarán convirtiéndose en productos de vanguardia de la más alta calidad totalmente fabricados en Italia, es el principal punto de partida de todo el ciclo de producción



CALIDAD

Desde siempre, la calidad es una preocupación básica en la creación de productos **RAASM**. Para obtenerla es indispensable la ejecución de un sinfín de pruebas altamente exigentes y rigurosas



FUNCIONABILIDAD

RAASM dispone de la más completa gama de productos para lubricación y distribución de fluidos. El objetivo es el de dar siempre una respuesta satisfactoria a las demandas de nuestros clientes y cubrir sus exigencias



Company with an
ISO 9001:2015
certified quality
management system

RAASM S.p.A.
36022 S. ZENO DI CASSOLA (VI)
Via Marangoni, 33 - ITALY

GF GESFLUID

GESTIÓN INTEGRAL DE EQUIPAMIENTOS INDUSTRIALES / INTEGRAL MANAGEMENT FOR INDUSTRIAL EQUIPMENTS

C/Candás, 20 Bajo - 33207 Gijón - Asturias - España
Tel. (+34) 984 05 00 90
gesfluid@gesfluid.es - www.gesfluid.es